

LOG CABIN KITS

FLOORPLANS & DESIGN CATALOG



Conestoga
LOG CABINS & HOMES
ConestogaLogCabins.com



TABLE OF CONTENTS



Cabin Kits
P. 11-22

ADA Cabin Kits
P. 23-27



Bathhouse Kits
P. 29-33

Bunkhouse Kits
P. 34-38



Multi- Purpose
Kits
P. 39-43

Why Conestoga?



Camping's #1 Rental Cabin Supplier:

For over 40 years Conestoga Log Cabins has served the needs of the US campground and resort industries. As the largest American supplier to these industries, we have earned the trust and respect of campground owners and resort property managers nationwide as well as overseas.

Conestoga built a reputation for designing and manufacturing attractive, economical, long-lasting rental cabins. Conestoga is the #1 supplier of commercial log cabins with thousands sold to campgrounds, resorts, and other commercial lodging properties.

A successful rental program requires log cabins that are not only beautiful and rugged but affordable and low-maintenance. Trust Conestoga to deliver log cabins that will contribute toward a healthy rental ROI year after year.

Call us to review cabin plans and see how we help campgrounds and resorts succeed. We are happy to provide references.



Images of products are for illustrative purposes only.



The Conestoga Difference

Real People and a Resourceful Website:

When Conestoga first started, we began producing log cabins as a small family business. Since then we've experienced tremendous growth but we have stayed true to our family roots. Conestoga Log Cabins is still run like a family business. Local people answer the phones, run the machinery and ship your log cabin kits. Our commitment to tradition and the people in our Conestoga family doesn't mean we don't embrace technology though. One look at our website (ConestogaLogCabins.com) will show you that we take full advantage of all the web offers. We have rich media content with multiple video streams, interactive cabin design capability, plenty of PDF downloads and enough pictures to keep our web host's servers very busy. Work with us and you'll see: through our people and our virtual presence, we really connect with the log cabin community.

Literally, Ready-To-Assemble:

Every log cabin kit we produce is built to exact specifications and precision-milled in our 100,000 sq. ft. Pennsylvania production facility. Every log cabin kit arrives at your building site ready-to-assemble. Our cabin kit comes with logs cut to exact size, precisely notched and individually coded and labeled. As the leading US producer of log cabin kits, Conestoga employs an array of CAD/CAM technology to ensure that every cabin kit can be assembled with ease. Not only are our kits easy to assemble, Conestoga's log cabins are also the most inclusive standard kits available. See the complete material listing in this catalog.



Images of products are for illustrative purposes only.

Conestoga Support

Conestoga Project Consultants - Trusted Advisors: We pair every new customer with an individual Conestoga project consultant who has only one job: to serve as a trusted advisor. Conestoga project consultants will help every step of the way to see your project through the idea stage, through design and finally see the walls going up. Our project consultants will meet your budget and work to make your project a reality.

Conestoga Technical Support: Because we design and manufacture every log cabin kit we ship, Conestoga has developed a comprehensive knowledge base of technical expertise. Not only do our technical support staff work closely with design, engineering, and production, they also interact with assembly teams, builders, project consultants, and the end users of our product. This comprehensive knowledge of our product line makes them world-class support specialists. Conestoga's technical support specialists are available to ensure a trouble-free and satisfying experience with your Conestoga kit. Our staff of support specialists is field-trained, service oriented and committed to perpetuating our reputation for outstanding customer support. Call them and see for yourself!



Images of products are for illustrative purposes only.

Conestoga Expertise

Conestoga's Custom Design Services:

While we offer an extensive line of standard models across a wide range of log building types, there may be unique requirements to a site or special features needed in a log building which demand a custom design. Conestoga Log Cabins offers an in-house custom design service to accommodate such needs. Our designers are experts in log cabin structures and bring years of experience in design, engineering and use of CAD (computer aided design). Conestoga's design department has advanced the use of BIM (building information modeling) for log cabin production and works closely with software developers to ensure that Conestoga stays on the leading edge of CAD technologies. Whether you need a simple adjustment to a floor plan, a reconfiguration of an existing building plan or conceptual sketches for a totally new design, Conestoga's custom design service is able and available.

Conestoga Cabin Assembly Service:

While many Conestoga log cabin kit buyers handle their own assembly, others chose to contract with a local builder. Choosing to build a Conestoga log cabin also provides you with the option to contract with us for assembly of your log cabin kits. Conestoga employs a network of professional assembly teams each of which is trained, experienced and endorsed by Conestoga Log Cabins. Our assembly teams arrive on site and complete the entire kit assembly process, built right and built to last. If your preference is to have someone assemble your cabin kits for you, there is no better team available than a Conestoga assembly team. Conestoga assemblers have successfully completed many campground and resort property log cabin kit installations. Campground and resort references are available upon request. Certain terms and conditions apply to cabin kit assembly services. Contact Conestoga to request Assembly Terms and Conditions or to speak with a project consultant.

Images of products are for illustrative purposes only.



Better Materials, Better Cabins

Conestoga's Everlast™ Log:

Every Conestoga log cabin is built using Conestoga's exclusive Everlast™ Log - the DNA of every Conestoga log structure. The Everlast™ Log is a laminated powerhouse of structural strength, stability and durability. Each log is kiln dried to an amazing 15% or less moisture content. Because of the physical properties of the log's construction, the Everlast™ Log resists warping, twisting, and settling which means every log delivers consistency in performance and structural stability. Each Everlast™ Log is precision-notched for exact fit and the extraordinary interlocked corners add structural integrity and weather-tight performance to all Conestoga buildings. Using our return wall system, we can create wall sections up to 26' long with notches from our milled 28' logs. Using longer logs, and securing the structure with the return walls, ensures superior water resistance. Finally, the lumber species used in our Everlast™ Logs is renowned for excellent working properties including cutting, nailing, sanding, staining, and finishing.



We've Always Been Green:

Often people interested in log cabins are also drawn to environmental wellness. Likewise, Conestoga is committed to environmental wellness and we demonstrate this commitment in our manufacturing methods. It begins with Conestoga's Everlast™ Log which is produced in concert with an Environmental Management System certified ISO-14001 assuring minimal environmental impact in timber harvesting. Our milling operations utilize cutting-edge fiber optimization software which nearly eliminates any material waste.



Images of products are for illustrative purposes only.

We Can Meet Any Energy Code

Our log cabins and homes have never failed to meet an energy code requirement. Logs benefit from thermal mass to capture and retain heat better than traditional homes. We have an advantage over other log cabin and home companies because our Everlast™ Log is engineered to allow for longer lengths, fewer twists, checks and considerably less gapping than traditional log structures. The result is less air infiltration and maintenance that provides a more comfortable energy efficient cabin that saves you money while enjoying your log cabin.

What is Thermal Mass? Thermal Mass is a concept in building design and construction that describes how the walls of the building provide “inertia” against temperature fluctuations. By their very nature log cabins and log homes differ from other construction techniques, because solid wood has both moderate R-value (insulation) and significant thermal mass.

Solid Wall

The single wall is perfectly suited for cabins that are located in moderate climates and/or are used seasonally.

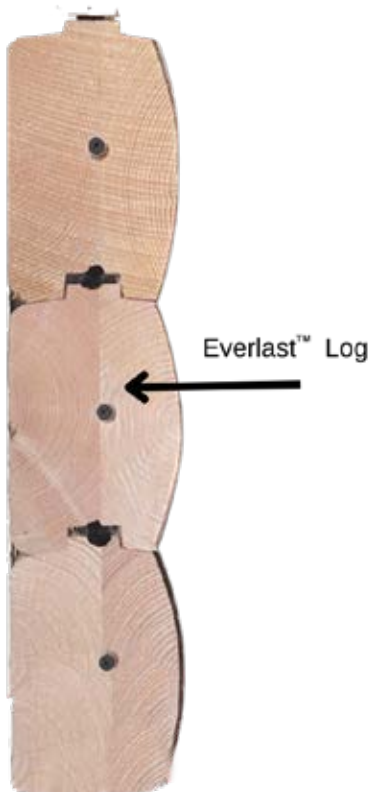

Solid Wall Siding Package

This is recommended for year round residences in cold weather climates. This package adds a layer of insulation and interior log siding to a single wall structure. This technology will meet or exceed the most stringent energy code requirements and lower utility bills, while maintaining the same log look inside your cabin.

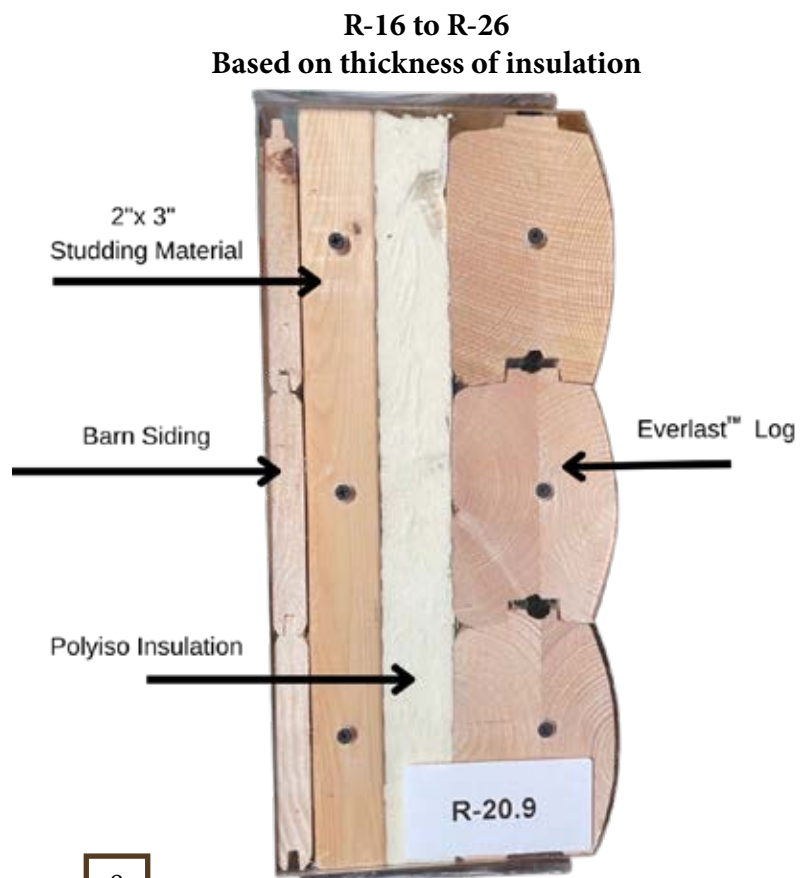

Conestoga's Everlast™ Log

Offers a low maintenance solution

- The Everlast™ Log is resistant to warping, twisting and settling because it is engineered to be structurally stable.
- The Everlast™ Log is resistant to movement, shrinkage, and checking, because it is kiln-dried to 15% or below moisture content.
- The Everlast™ Log is resistant to decay, because it is kiln-dried below the 19% fungi threshold.
- The Everlast™ Log is notched, cut to length, drilled, and mortised for all electric and fasteners.
- The Everlast™ Log can be up to 28' long, which eliminates unsightly log joints, reduces the possibility of air and water infiltration and improves overall energy efficiency.
- The Everlast™ log is 50% stronger than traditional logs.

The Stronger and More Stable Engineered Log



D-Log

This cross-section of glued surfaces is what gives the Everlast log its superior strength.

The two to three interior pieces are laminated together with a continuous height outside piece on each side.

D-Log has a round face on the exterior and a flat face on the interior.

Continuous height outside pieces.

H-Log

Everlast™ Log Advantages

- The Everlast log's wood is harvested using sustainable forestry techniques.
- It is lighter, making it easier to handle during installation.
- It possesses very tight growth rings and offers preferred stability characteristics when exposed to moisture fluctuations.
- It can be stained with consistent and excellent results.
- It is very workable when cutting and drilling.
- It has excellent nailing characteristics.

Flat Log has a flat face on the exterior and interior faces.

Conestoga Log Cabin Resort Owners

"We have had a wonderful experience and great public use of the camper cabins at Carolina Beach State Park and believe some of our fellow state park managers would be interested in Conestoga Cabins."

Carolina Beach State Park, NC

"My family's summer camp for children dates back to the early 1930's. When it came time to renovate and build our future we turned to Conestoga Log Cabins and we couldn't be happier! I could go on and on about the quality of the materials, detailed thinking that goes into each building and the superior customer service. You don't need to look anywhere else for log cabin kits. These cabins are everything you could dream of. Conestoga's log cabin kits are the gold standard in the industry. We did our homework and checked out several manufacturers. Whether it's a hot, hot summer day or a cool fall evening, the cabins are tight and very comfortable. Their log cabin kits are built to last. Quality at every step of the relationship with Conestoga. Highly recommend."

Camp Emerson, MA

Visit our website for more testimonials!

The Most Complete LOG CABIN Package in the Industry

Floor System:

- Floor Joists
- Metal Floor Trim
- Fasteners
- 2" x 6" Tongue & Groove Flooring

Log Walls:

- Laminated Everlast™ Kiln-Dried Log Wall System
- Gable End Logs
- Caulking
- Emseal Gasket Material
- 80d/40d Nails

Windows:

- Vinyl Windows
- 2" x 4" Window Bucks
- Interior & Exterior Window Trim

Doors:

- Insulated Metal 9-lite 2 Panel Exterior
- Pre-Hung 6 Panel Wood Interior Doors
- 2" x 4" Door Bucks
- All Door Hardware
- Interior & Exterior Door Trim Fasteners

Loft Floor System (if applicable):

- Laminated Floor Joists
- Joist Hangers
- 2" x 6" Tongue & Groove #1 Yellow Pine Loft Floor Boards
- Pre-manufactured Staircase & Railings or Loft Ladder (cabin size specific)
- Loft Railings, Posts & Pickets
- Fasteners

Roof System:

- Laminated Ridge Beam
- Laminated Mid-Roof Beams
- 15 lb. Felt Paper
- Gable End Trim
- 45 yr. Metal Roof
- 2" x 6" Tongue & Groove Yellow Pine V-Groove Roof Boards

Interior Finish Materials:

- 2"x 4" Interior Partition Walls
- 2"x 6" Interior Partition Walls (Plumbing Walls)
- 1"x 6" Barn Siding Interior Wall Boards
- Interior Baseboard Trim
- Interior Door Trim
- Pre-Hung Interior Wood Doors
- Passage Door Hardware
- Private Door Hardware
- Fasteners

Porch Materials:

- Pressure Treated Floor Joists
- Joist Hangers
- 2" x 6" Pressure Treated Decking
- Porch Posts, Railings & Pickets
- Porch Roof Beams
- All Roofing Materials & Trims
- Gable End Webbing

Electrical:

- Electrical Wiring & Grommets
- Boxes, Switches, Outlets & Covers
- Interior Light Fixtures & Bulbs
- Smoke Detectors
- Exterior Lights & Bulbs

Pre-Cut Materials:

- Pre-cut/Pre-drilled Logs
- Pre-cut Floor Boards
- Pre-cut Roof Beams & Peak Logs
- Pre-cut Interior & Exterior Window/Door Trims

Options:

- Decks
- Porch Extensions & Side Porches
- Custom Doors & Windows
- Log Wall Insulation Packages
- Floor & Ceiling Insulation
- Interior Polyurethane
- Exterior Stain
- Supplemental Heating & Cooling Unit
- Kitchenette
- Screen Door Kit

Heavy Roof and Floor Loading, High Altitude, Seismic, Hurricane, Nordic, Tropical and Other Extreme Weather Building Specifications Are Available as an Upgrade.

Cabin size will determine floor and roofing system, as well as window material.

Cabin Kits

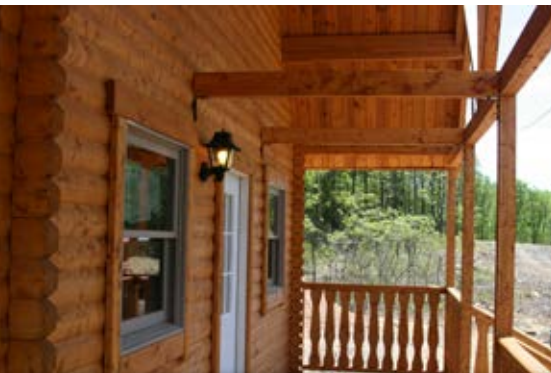

SPECIFICATIONS

1080 SQF | 2 BR | 1 BA

KIT OVERVIEW

The Mountain King Commercial Log Cabin Kit is one of Conestoga Log Cabins' best sellers and we're not the least bit surprised. These 20' x 36' log cabin kits are the ultimate in cabin luxury. Your guests will think it is the perfect getaway from the stresses of daily life.

- **Living Area**
- **Loft Space - 12/12 Roof allows ample head clearance**
- **Kitchen Area**
- **6' Covered Porch**
- **Bathroom**
- **Bedroom**

Images of products are for illustrative purposes only.

MOUNTAIN KING

Main Floor

Loft Area

20'

36'



Cabin Kits



SPECIFICATIONS

740 SQF | 2 BR | 1 BA

KIT OVERVIEW

This 20' x 27' log cabin's bedroom and full bath are coupled with an efficient, open kitchen, roomy great room, and extra loft space making it a choice selection for vacationers everywhere. The Brandywine log cabin package is the perfect addition to your campground or resort property.

- **Great Room**
- **6' Covered Porch**
- **Bedroom with closet**
- **Bathroom**

BRANDYWINE

Main Floor
20'

Loft Area

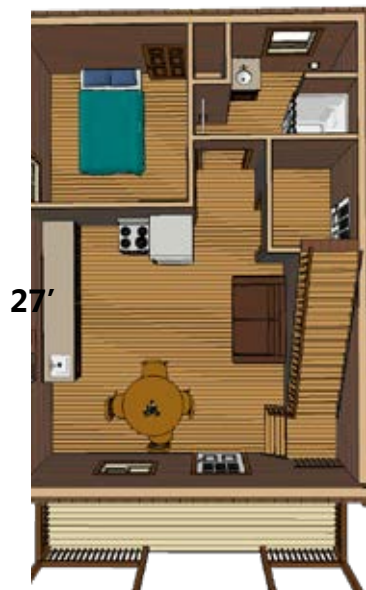

Images of products are for illustrative purposes only.

Cabin Kits



SPECIFICATIONS

727 SQF | 2 BR | 1 BA

KIT OVERVIEW

As the name implies, the Vacationer is the perfect vacation log cabin. These log cabin kits are ideal for the campground and resort owner who wants spacious cabins for families, individuals or couples who like plenty of room. Placed in the right setting, the Vacationer is a guest's dream come true and a resort owner's most profitable investment.

- Living Area
- Covered Porch
- Two Bedrooms
- Private Bathroom
- Loft Storage Area with 12/12 Pitch

Images of products are for illustrative purposes only.

VACATIONER

Main Floor

Loft Area

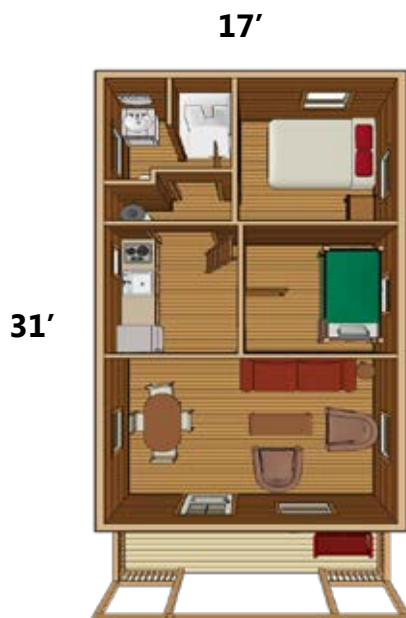

Cabin Kits



SPECIFICATIONS

667 SQF | 1 BR | 1 BA

KIT OVERVIEW

Is your RV campground looking to become more profitable? Is your camping resort ready for upgrades? The Hickory Hill can be the answer to both of these questions. By adding small cabin kits, your business increases options for your guests.

- Great Room
- Loft
- Bedroom
- Private Bathroom
- Covered Porch
- Full size stairs

Images of products are for illustrative purposes only.

HICKORY HILL

Main Floor
18'

Loft Area

27'



Cabin Kits

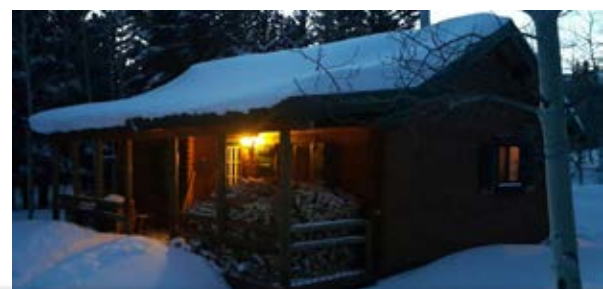

SPECIFICATIONS

600 SQF | 2 BR | 1 BA

KIT OVERVIEW

This cabin is a roomy 600 SQF with 2 bedrooms, a bathroom, living area and room for a kitchen. Additional storage is available above the bathroom.

- Living Area
- Storage Space above bathroom
- Kitchen Area
- Covered Porch
- Bathroom
- Bedroom

TROUT RUN

Main Floor

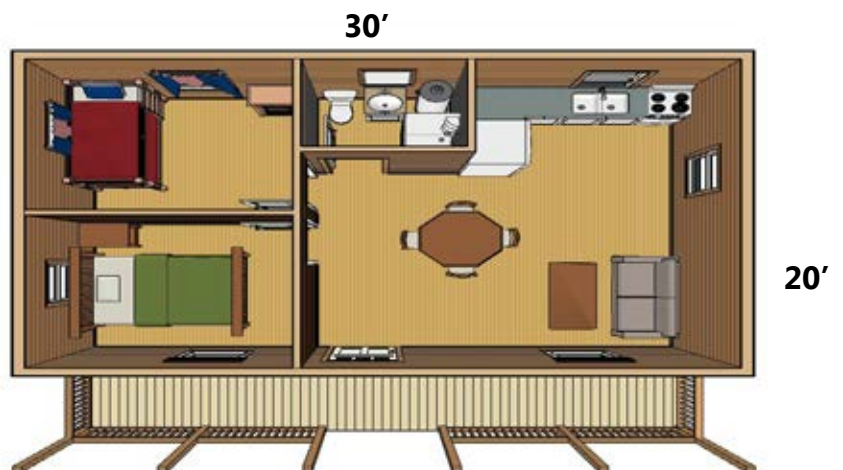

Cabin Kits

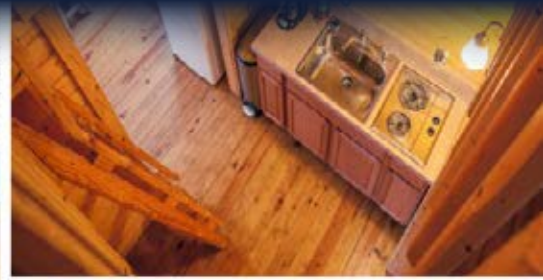

SPECIFICATIONS

580 SQF | 2 BR | 1 BA

KIT OVERVIEW

Your guests will see our 14'-7" x 27' log cabin package as an idyllic cozy cottage. The Heritage is well suited to be a weekend getaway and vacation spot. This log cabin can be rented by family and friends who want to share the joys of log cabin living together. You'll soon discover that the Heritage will be in high demand throughout your rental season.

- Living Area
- Loft Storage Space with ample head clearance
- Kitchen Area
- Covered Porch
- Bathroom
- Bedroom

Images of products are for illustrative purposes only.

HERITAGE

Main Floor

27'

14'7"



Loft



Cabin Kits



SPECIFICATIONS

424 SQF | 1 BR | 1 BA

KIT OVERVIEW

The dictionary defines an outdoorsman as a person devoted to outdoor sports and recreational activities, as hiking, hunting, fishing, or camping. If that describes your guests, then this cabin is made for your property! It is designed for the outdoorsman who doesn't want to completely rough it appreciates modern comforts.

- Living Area
- Storage Loft Space with 12/12 Pitch
- Kitchen Area
- 6' Covered Porch
- Private Bathroom
- Bedroom

Images of products are for illustrative purposes only.

OUTDOORSMAN

Main Floor



Loft



Cabin Kits



SPECIFICATIONS

408 SQF | 1 BR | 1 BA

KIT OVERVIEW

The Bear Creek Log Cabin is ideal for family camping vacations. Families will use the Bear Creek as a seasonal getaway spot. Build log cabins on your property and people will love to visit and look forward to returning year after year.

- Living Area
- Storage Loft above Bathroom
- Kitchen Area
- 6' Covered Porch
- Private Bathroom
- Bedroom

BEAR CREEK

Main Floor

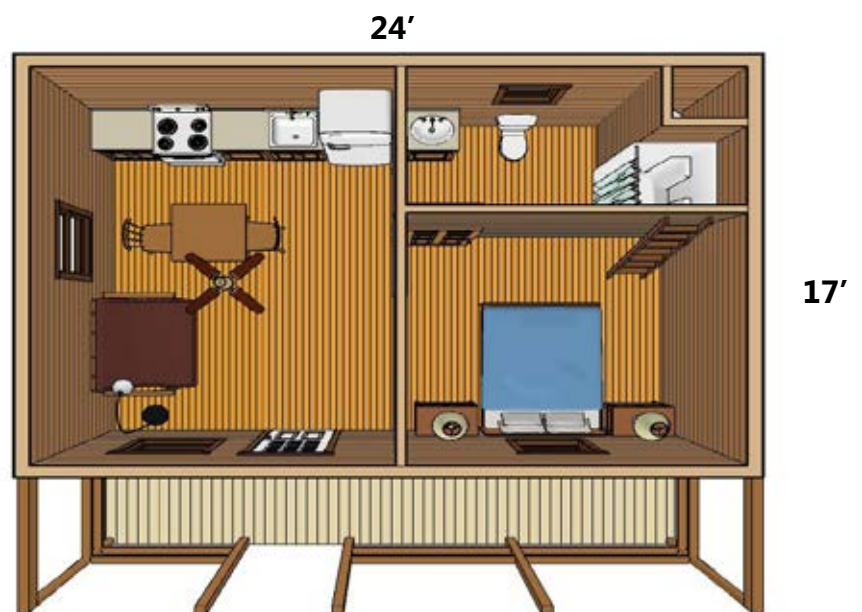

Images of products are for illustrative purposes only.

Cabin Kits



SPECIFICATIONS

292 SQF | 1 BR | 1 BA

BOULDER LODGE

Two Room

One Room

KIT OVERVIEW

Commercial buyers will find the Boulder Lodge log cabin affordably priced and easy to assemble. You can choose from either a two-room with bath model or one-room model that really opens up the entire interior of the cabin. Campground resort buyers comment on the low maintenance and durable qualities of the Boulder Lodge.

- Living Area w/ Kitchenette
- Covered Porch
- Storage Space
- Private Bathroom
- Bedroom

Images of products are for illustrative purposes only.

20'

14'7"



Cabin Kits

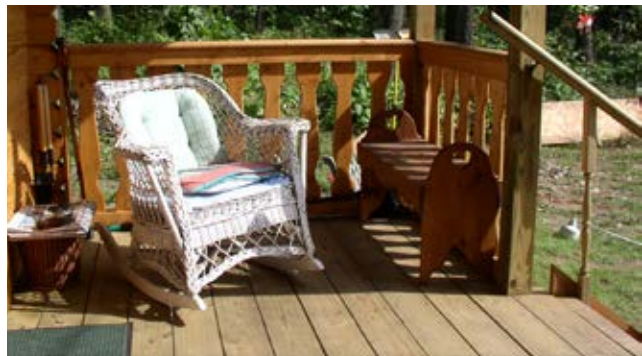

SPECIFICATIONS

280 SQF | 1 BR | 1 BA

SERENITY

Main Floor

KIT OVERVIEW

You'll quickly see an investment pay off with this sturdy, low maintenance, cost-effective log cabin. Your guests will have plenty of room to relax with the morning paper or a good book on the covered front porch. Considering its size and standard equipment, this log cabin package is a real value.

- Living Area w/ Kitchenette Optional
- Covered Porch
- Bathroom
- Bedroom

Images of products are for illustrative purposes only.

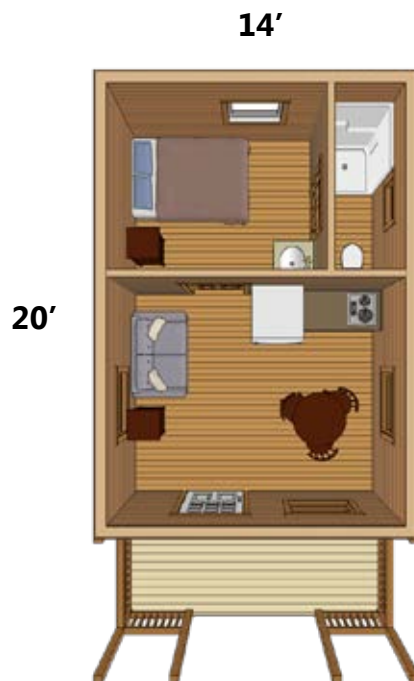

Cabin Kits



SPECIFICATIONS

232 SQF

SHENANDOAH/DURANGO

Two Room - Shenandoah
2 BR | - BA

One Room - Durango
1 BR | 1 BA

KIT OVERVIEW

These two room log cabins are ideal rental units for camping families. the Shenandoah has a separate bedroom for the parents. The Durango offers a bathroom for guests who want private shower facilities.

- Living Area (optional)
- 6' Covered Porch
- Private Bathroom
- Bunkroom

16'7"

14'



Images of products are for illustrative purposes only.



SPECIFICATIONS

195 SQF

GETAWAY/ASPEN

Getaway
1 BR | 1 BA

Aspen
2 BR | - BA

KIT OVERVIEW

Cozy, rustic and no-frills, these cabins are perfect for any setting. The Aspen still provides plenty of room to sleep six, while the Getaway includes a private bathroom. Add a microwave and refrigerator to complete the living accommodations.

- **Covered Porch**
- **Bunkroom**
- **Bathroom**

15'

13'

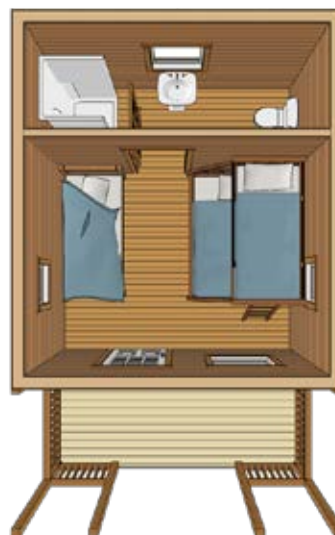

Images of products are for illustrative purposes only.

Larger Cabin Kits

SUSQUEHANNA
1,143 SQF
3 BR | 1 BA

- Great Room
- 3 Bedrooms
- Private Bathroom
- Loft Space
- Kitchen Area
- Covered Front Porch

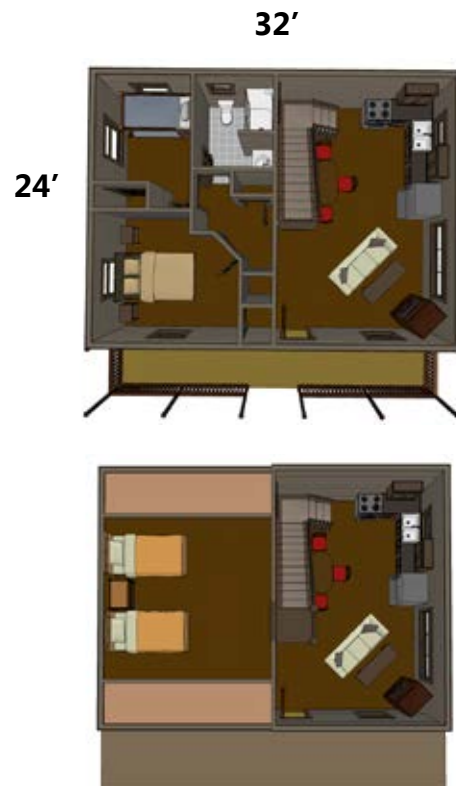

MEADOWBROOK
1,215 SQF
3 BR | 2.5 BA

- Suite with private bathroom
- 2 additional bedrooms
- Open Floor Plan
- Full Kitchen
- Bathroom
- Additional 1/2 Bath



Images of products are for illustrative purposes only.

ADA Cabin Kits



SPECIFICATIONS

143 or 169 SQF

KIT OVERVIEW

The Conestoga and Pioneer are one-room cabins that offer sleeping accommodations for up to four people. Perfect as rental cabins for families or as charming guest accommodations. Sturdy construction and all the features of a true log cabin built into a small, easy-to-manage kit.

- **Covered Porch**
- **Bunkroom**

Additional Materials Included w/ ADA Cabins

- *ADA Strobes*

Images of products are for illustrative purposes only.

CONESTOGA/PIONEER



Conestoga
1 BR | - BA
143 SQF

11'



Pioneer
1 BR | - BA
169 SQF

13'

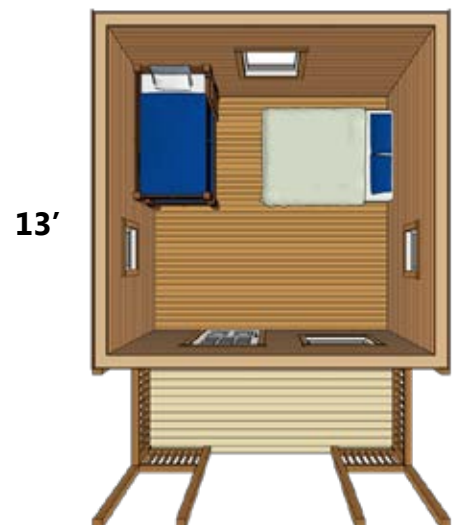

ADA Cabin Kits



SPECIFICATIONS

394 SQF | 1 BR | 1 BA

FRONTIER



KIT OVERVIEW

The Frontier Commercial Log Cabin was designed specifically for a campground that wanted to offer their campers more than just bare bones cabins. They wanted to upgrade to cabins that would have broader appeal. The Frontier offers the true log cabin experience without forgoing modern conveniences.

- Covered Porch
- Private Bedroom
- Private Bathroom
- Kitchen Area
- Additional Living Space
- ADA Compliant

Images of products are for illustrative purposes only.

14'7"

27'



Additional Materials Included w/ ADA Cabins

- ADA Strobes

ADA Cabin Kits



SPECIFICATIONS

SPEARFISH

280 SQF | 1BR | 1 BA

KIT OVERVIEW

All of the necessities fit nicely into this small log cabin kit. The Spearfish sleeps 4 comfortably and has a front porch for relaxing after a day of adventure. An excellent choice at an affordable price.

- **Covered Porch**
- **Private Bathroom**
- **Common Area**
- **ADA Compliant**

Additional Materials Included w/ ADA Cabins

- *ADA Strobes*

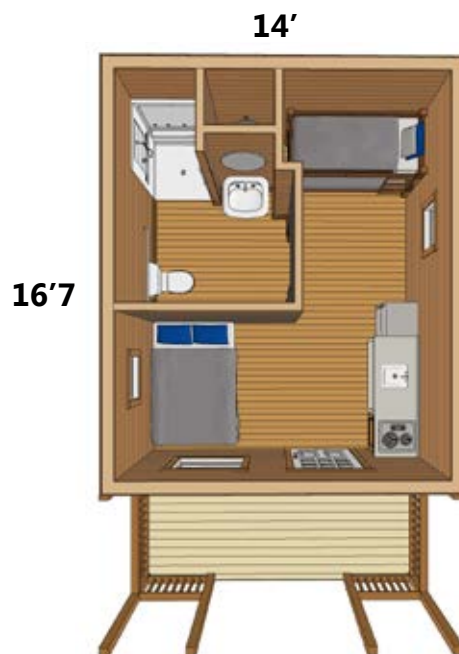

Images of products are for illustrative purposes only.

ADA Cabin Kits



SPECIFICATIONS

760 SQF | 2 BR | 1 BA

YUKON



KIT OVERVIEW

The five room Yukon is sure to meet all of your guests' needs. For extra sleeping space consider adding a futon. The kitchen is roomy enough for appliances and cabinets. Kids will love the smaller bedroom that is perfect for bunk beds. Both bedrooms have closets where guests can store their belongings.

- **Covered Porch**
- **Private Bathroom**
- **Bedroom**
- **Closet Space**
- **Kitchen Area**
- **ADA Compliant**

Images of products are for illustrative purposes only.



Additional Materials Included w/ ADA Cabins

- *ADA Strobes*

ADA Cabin Kits



SPECIFICATIONS

66g SQF | 1 BR | 1 BA

HEMLOCK

KIT OVERVIEW

Guests will return to rent the Hemlock year after year. This spacious cabin offers a private bedroom and bathroom. The family room offers room for a dining table and sofa with a kitchen large enough to make that night's meal.

- Covered Porch
- Private Bathroom
- Bedroom
- Closet Space
- Kitchen Area
- ADA Compliant

Images of products are for illustrative purposes only.

18'7"



36'

Additional Materials Included w/ ADA Cabins

- ADA Strobes

Bathhouse Kits



SPECIFICATIONS

232 SQF

KIT OVERVIEW

The Durango Bathhouse offers the convenience of modern facilities housed in a rugged log cabin. Owners find it to be attractive and low maintenance. This bathhouse is suitable for state parks, campgrounds, RV parks and other applications. It can easily be outfitted to be compliant with ADA (Americans with Disabilities Act).

- **Separate Entrances**
- **2 Private Bathrooms**
- **Electrical Outlets**
- **Storage Area**

Images of products are for illustrative purposes only.

DURANGO BATHHOUSE

16'7"

14'

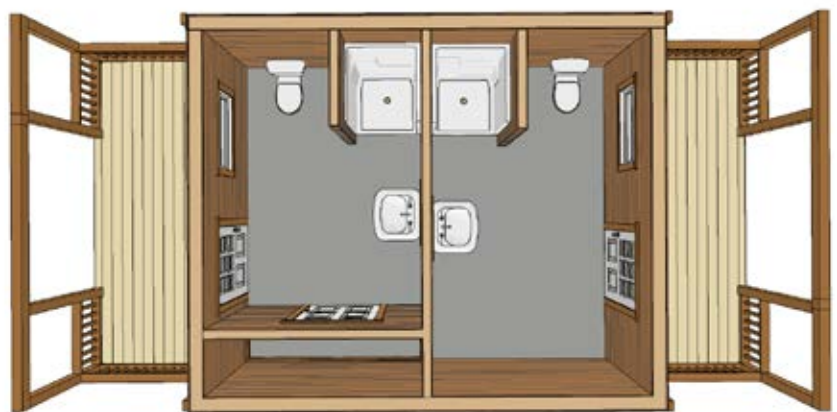

Additional Materials Included w/ Bathhouse

- *Life Safety Code NFPA 101 Emergency Lighting*
- *Panic Hardware Entry Doors*
- *Obscure/ Privacy Glass Windows and Doors*
- *Plumbing Supplies not Included in Kit*

Bathhouse Kits



SPECIFICATIONS

393 SQF

***Plumbing Supplies not Included in Kit*

KIT OVERVIEW

Divided into two equal rooms that are mirror images of each other. Each side will house two sinks, two private shower stalls and two toilets. Covered porches flank both ends.

- **Covered Porches**
- **4 Private Facilities**
- **Shared Dressing/Sink Area**

ALPINE BATHHOUSE

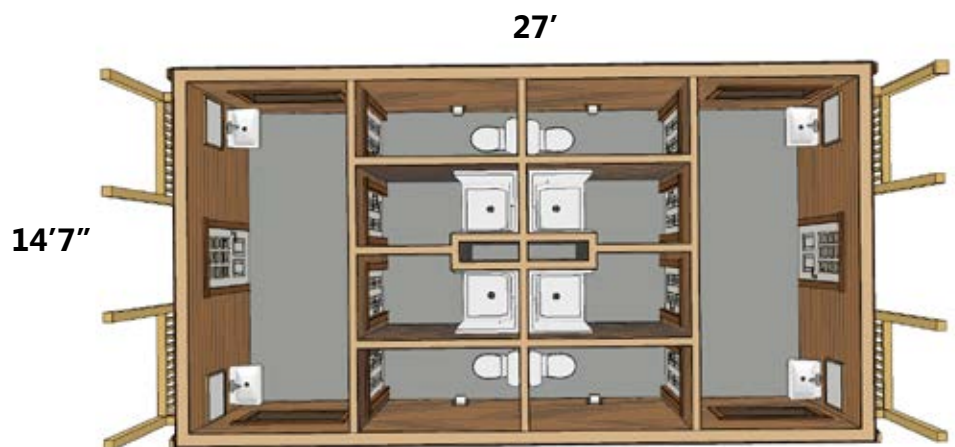

Additional Materials Included w/ Bathhouse

- *Life Safety Code NFPA 101 Emergency Lighting*
- *Panic Hardware Entry Doors*
- *Obscure/ Privacy Glass Windows and Doors*

Images of products are for illustrative purposes only.

Bathhouse Kits



SPECIFICATIONS

720 SQF

KIT OVERVIEW

Mountain King bathhouses feature four rooms each with its own entrance. One room is designed to be a large ADA compliant restroom. The design also provides for laundry room that guests will be happy to use.

- **Separate Entrances**
- **4 Rooms**
- **Laundry Room**
- **Storage Area**
- **ADA Compliant Bathroom**

Images of products are for illustrative purposes only.

MOUNTAIN KING BATHHOUSE

***Plumbing Supplies not Included in Kit*

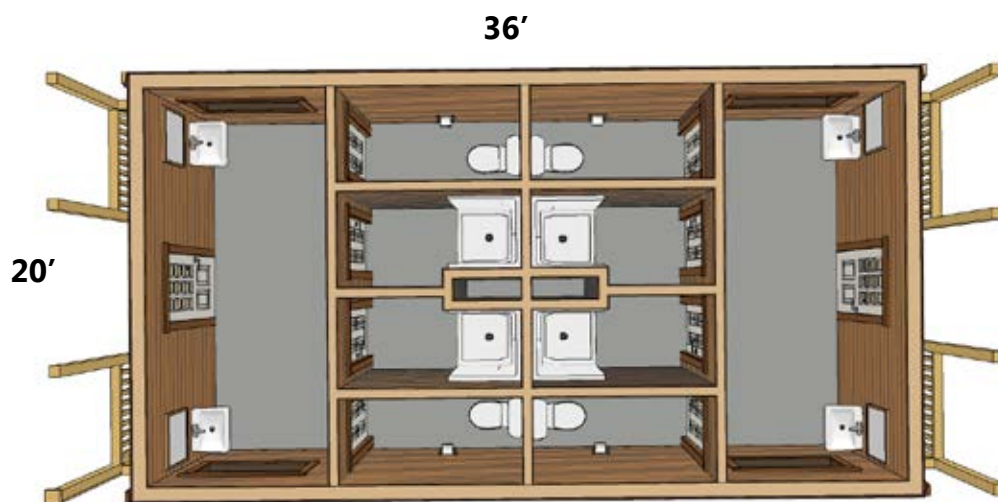

Additional Materials Included w/ Bathhouse

- *Life Safety Code NFPA 101 Emergency Lighting*
- *Panic Hardware Entry Doors*
- *Obscure/ Privacy Glass Windows and Doors*

Bathhouse Kits



SPECIFICATIONS

840 SQF

KIT OVERVIEW

This attractive log cabin kit bathhouse features eight separate rooms. Six private bathrooms are spacious and identical with space for shower stall, toilet and sink. They could easily be used as family restrooms. All you have to do is add hooks and benches for your guests' comfort.

- **Covered Porches**
- **7 Private Bathrooms**
- **Laundry Area**

Images of products are for illustrative purposes only.

TWIN GROVE BATHHOUSE

***Plumbing Supplies not Included in Kit*

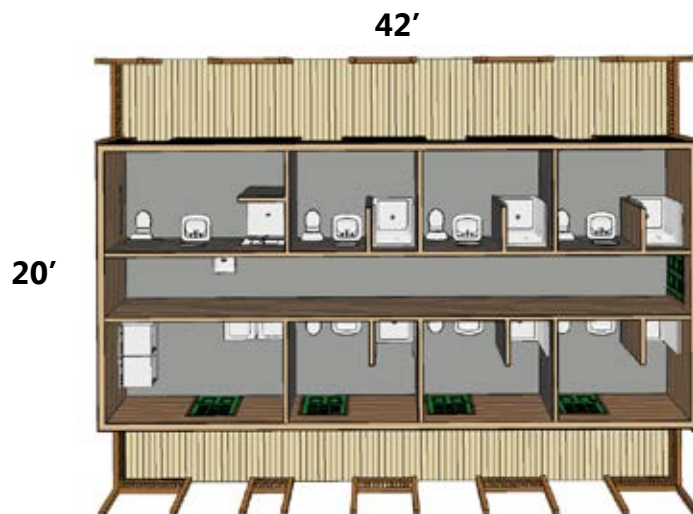

Additional Materials Included w/ Bathhouse

- *Life Safety Code NFPA 101 Emergency Lighting*
- *Panic Hardware Entry Doors*
- *Obscure/ Privacy Glass Windows and Doors*
- *ADA Strobes*

Bathhouse Kits



SPECIFICATIONS

1,296 SQF

KIT OVERVIEW

The perfect compliment to any campground that accomodates large groups of people. With space for 18 shower stalls, 6 sinks and 6 toilets no one will wait in line.

- **Multiple Entrances**
- **18 Shower Spaces**
- **6 Toilets**
- **Laundry Area**
- **Washing Area**

Images of products are for illustrative purposes only.

GRAND BERKSHIRE BATHHOUSE

***Plumbing Supplies not Included in Kit*

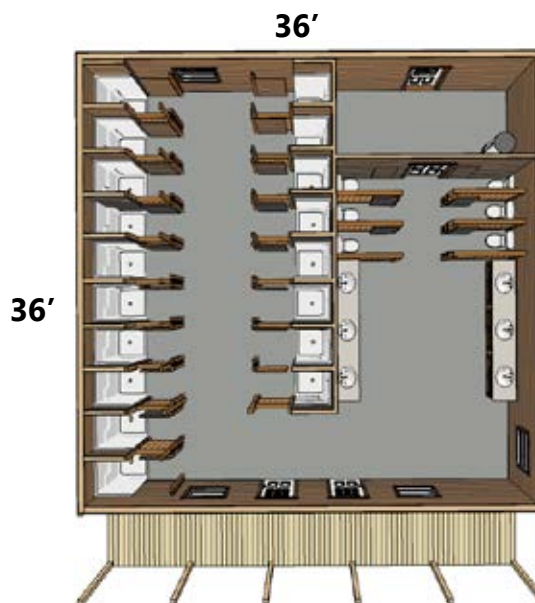

Additional Materials Included w/ Bathhouse

- *Life Safety Code NFPA 101 Emergency Lighting*
- *Panic Hardware Entry Doors*
- *Obscure/ Privacy Glass Windows and Doors*

Bunkhouse Kits



SPECIFICATIONS

280 SQF

KIT OVERVIEW

Even though the Cub Lodge is Conestoga's smallest bunkhouse, it still has all the charm. This is a traditional one room bunkhouse in which 8 campers can comfortably fit.

- Large open room
- Sleeps 8 in bunkbeds
- Covered porch

Additional Materials Included w/ Bunkhouse

- Life Safety Code NFPA 101 Emergency Lighting
- Panic Hardware Entry Doors

CUB LODGE BUNKHOUSE

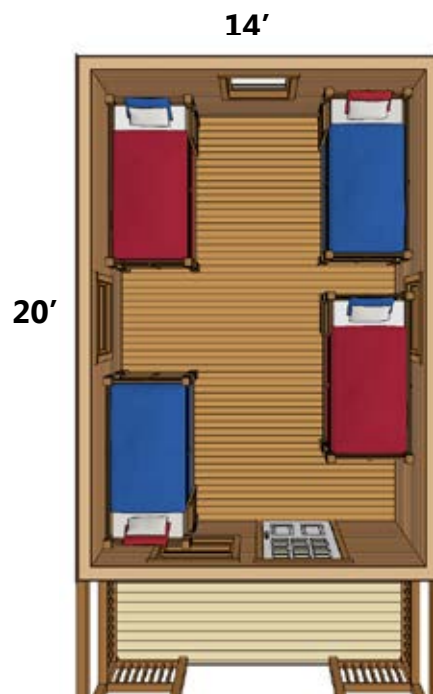

Images of products are for illustrative purposes only.

Bunkhouse Kits



SPECIFICATIONS

393 SQF

KIT OVERVIEW

Sleep 16 or 12 with your choice of the Elk Lodge Bunkhouse with a bathroom or without. This is the most versatile bunkhouse floorplan that we offer!

- **Sleeps 16 or 12**
- **Choice of bathroom**
- **Covered Porch**
- **Private bedroom or space for bathroom facilities**

Additional Materials Included w/ Bunkhouse

- *Life Safety Code NFPA 101 Emergency Lighting*
- *Panic Hardware Entry Doors*

Images of products are for illustrative purposes only.

ELK LODGE BUNKHOUSE

With Bathroom

Without Bathroom

14'7"

14'7"

27'



27'



Bunkhouse Kits



SPECIFICATIONS

527 SQF

KIT OVERVIEW

Affordable with the capacity to sleep twelve in bunkbeds. This floorplan features 2 bunk rooms with 2 bathrooms in between.

- **Two bunk rooms**
- **Capacity to sleep 12**
- **Bathroom facilities**

Additional Materials Included w/ Bunkhouse

- *Life Safety Code NFPA 101 Emergency Lighting*
- *Panic Hardware Entry Doors*

Images of products are for illustrative purposes only.

BEAR LODGE BUNKHOUSE

***Plumbing Supplies not Included in Kit*

17'

31



Bunkhouse Kits



SPECIFICATIONS

840 SQF

KIT OVERVIEW

Visitors and guests will still feel like they are roughing it but with a soft, safe place to sleep and hot water to shower. The Moose Lodge has ample storage space and the covered porch provides a place to relax in the evenings after a day in the sun.

- **Sleeps 20 in bunk beds**
- **Bunk rooms have separate entrances**
- **4 shower spaces**
- **3 sink spaces**
- **3 toilet spaces**

Images of products are for illustrative purposes only.

MOOSE LODGE BUNKHOUSE

***Plumbing Supplies not Included in Kit*

42'

20'



Additional Materials Included w/ Bunkhouse

- *Life Safety Code NFPA 101 Emergency Lighting*
- *Panic Hardware Entry Doors*

Bunkhouse Kits



SPECIFICATIONS

980 SQF

KIT OVERVIEW

Barracks style lodging with vaulted ceilings and room to spare. Campers can spread out and enjoy their own space while still feeling like they are part of the group.

Our newest bunkhouse kit with an incredible 980 square feet.

- Open sleeping area
- Capacity to sleep 26
- Half bathroom
- Covered front porch

Images of products are for illustrative purposes only.

EXPLORER BUNKHOUSE

20'

49'



Additional Materials Included w/ Bunkhouse

- Life Safety Code NFPA 101
- Emergency Lighting
- Panic Hardware Entry Doors

Multi-Purpose Kits



SPECIFICATIONS

480 SQF Shown

KIT OVERVIEW

Conestoga's pavilion kits are made from high-quality lumber and are designed to offer shelter from the elements as well as provide shade. Each pavilion kit includes a 45-year warranty metal roof for added durability. We can customize the plan to any size requirement and even add walls for a greater sense of enclosure.

SYCAMORE PAVILION

Our Pavilion Kits are available in any configuration or size.

Add walls to separate sections, keep it completely open or enclose it.

The options are limitless. Whatever your application we can customize our pavilion kit to fit your Park or Campground.

Multi-Purpose Kits

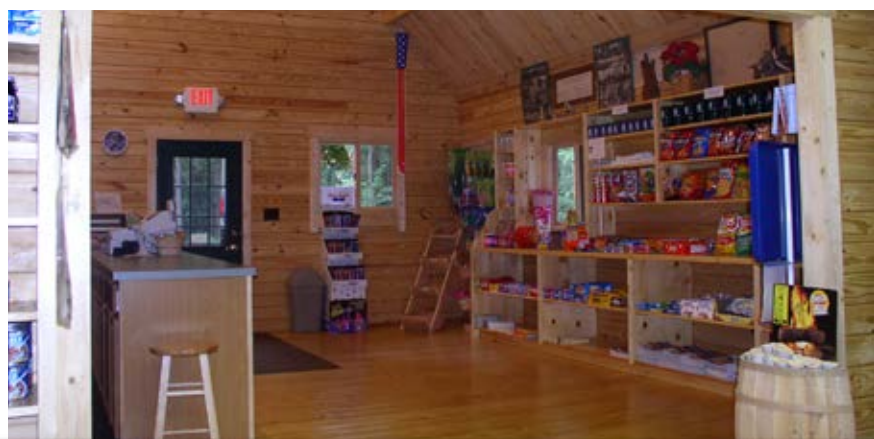

SPECIFICATIONS

1240 SQF

KIT OVERVIEW

The Trap Pond Multi-Purpose Cabin Kits are incredibly versatile and useful in a wide range of commercial applications. At over 1,200 square feet this building is ready-to-use log built space.

Since the space of the Trap Pond is completely adaptable, a floorplan can be created to address your property's needs. Areas can be added for storage, restrooms, reception or just about anything else you might need.

- **1,200+ of flexible space**
- **A 6' covered front porch**
- **Additional loft space above**

Images of products are for illustrative purposes only.

TRAP POND



Additional Materials Included w/Multi-Purpose Buildings

- *Life Safety Code NFPA 101 Emergency Lighting*
- *Panic Hardware Entry Doors*

Multi-Purpose Kits



SPECIFICATIONS

1700 SQF

LINCOLN

50'

KIT OVERVIEW

The main room of the Lincoln is the trading post. Just off the trading post, you'll find an oversized supply closet and the mechanical room. Two ADA compliant restrooms with outside private entrances are located at the front of the building. In addition, there are two staff bedrooms also with private outside entrances.

- **2 restrooms**
- **Separate staff quarters**
- **Sales area**
- **Supply closet**
- **Concessions area**

Images of products are for illustrative purposes only.

34'



Additional Materials Included w/Multi-Purpose Buildings

- *Life Safety Code NFPA 101 Emergency Lighting*
- *Panic Hardware Entry Doors*

Multi-Purpose Kits



SPECIFICATIONS

1840 SQF

KIT OVERVIEW

At 1840 square feet, the standard Cropper Island kit features four large rooms, two half ADA restrooms and a huge wrap around covered porch. The expansive covered porch is a great location for rockers, vending machines or whatever appeals to your guests.

- Check-in/Check-out area
- Laundry facility
- Arcade/Game room
- Private meeting areas
- Snack bar
- Fitness center

Images of products are for illustrative purposes only.

CROPPER ISLAND

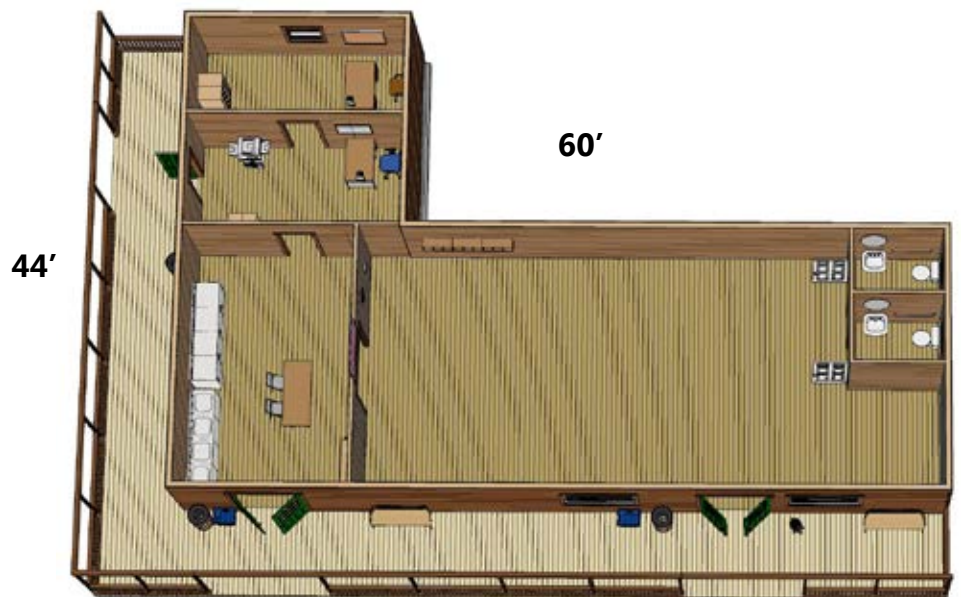

Additional Materials Included w/Multi-Purpose Buildings

- Life Safety Code NFPA 101 Emergency Lighting
- Panic Hardware Entry Doors

Multi-Purpose Kits



SPECIFICATIONS

3000 SQF

HURON

KIT OVERVIEW

This attractive building is almost completely surrounded by covered and uncovered porches. The main entrance is through a set of double doors that leads into the main hall featuring vaulted ceilings. A large kitchen can be found at the rear of the building with its own entrance.

- **Expansive covered porches**
- **Trading post**
- **Kitchen**
- **Commissary**
- **Private restrooms**
- **Storage**

Images of products are for illustrative purposes only.

40'



Additional Materials Included w/Multi-Purpose Buildings

- *Life Safety Code NFPA 101 Emergency Lighting*
- *Panic Hardware Entry Doors*

Product Details

Windows

Conestoga uses high quality casement and double hung windows. As a standard all our windows are Low-E/Argon and utilize Warm-Edge Technology to enhance energy performance.



Flooring

Conestoga uses only high-quality, cabin grade flooring.

Upgrades available to any type of finished flooring.



Metal Roof (Shingles Optional)

29 GAUGE FULL HARD STEEL



ZINC PHOSPHATE PRE-TREATMENT
ZINC COATING

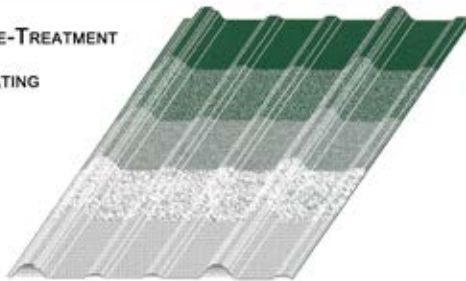

- Seamless Roofing System
- Sustainable and longer lasting than a traditional roof, with a life expectancy of 45 years
- Will never decompose and when it is time to be replaced, steel is recyclable and reusable
- Shingles roof optional

45-Year Paint Warranty

Engineering Services

Conestoga Log Cabins & Homes offers log cabin kits that are fully engineered, pre-cut and ready-to-assemble. Our standard log cabin kits range from cozy 11 x 13 camping cabins to spacious 3,000+ SQF grand multi-purpose buildings, bathhouses, and bunkhouses.

Our line of log cabin kits are designed to appeal to a wide range of needs. Moreover, we offer custom design services and will engineer and produce a log cabin kit to meet your specific needs.

Want to see what your custom designed building will look like? We can do one better, you can walk through it with our new "fly through" 3D videos. We can even furnish it just how you would like to see it! Or look at it from an aerial view and see just how much space your new log building has to offer.

Images of products are for illustrative purposes only.

Assembly

We make it easy for home owners or builders without log home construction experience to build our log cabins. Every log has a label attached with a unique number that corresponds to plan drawings. This unique number enables you to know the exact location of every log during the construction process.

The numbering system not only ensures organization and easy identification, but facilitates technical support if needed. If a question arises during construction our technical support team is available to provide assistance. By providing the log number our technicians will know exactly what you're working on and how to better assist you.

In addition to our user friendly log numbering system, detailed assembly instructions, plans and diagrams accompany every Conestoga log home kit. Technical support phone and email is included with every purchase. In addition, an assembly crew can be made available to travel worldwide. Check us out on YouTube for more construction tips.

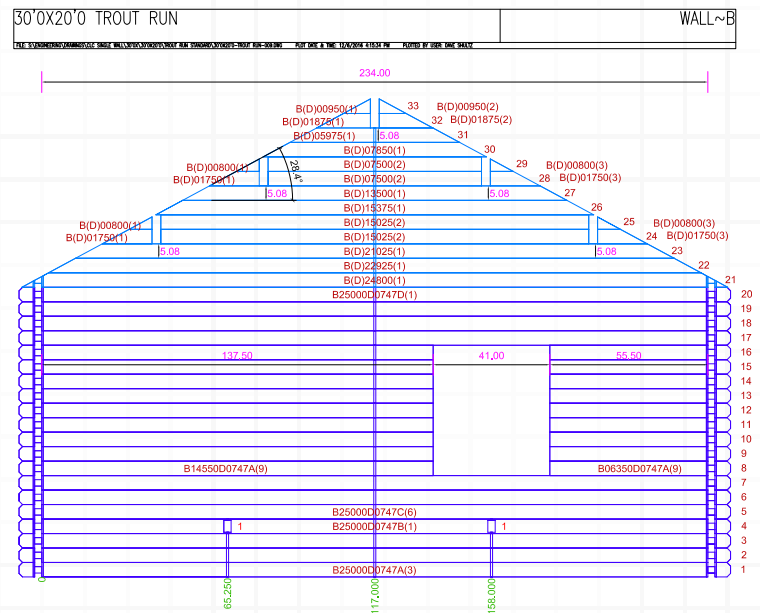

Need help with your log home assembly kit?

In case a question arises, Conestoga's knowledgeable staff is available for assistance. Conestoga is committed to providing customers with quality support, materials and supplies.

Service

Whether you're an individual or an organization, Conestoga has experienced construction teams available to assemble our structures within the United States and abroad.

With a Conestoga team you can be assured you have the skill and expertise of trained craftsmen. Conestoga's teams provide a knowledge level that ensures an efficient and quality installation at a competitive price.

For most individuals and organizations, time seems to be in demand. Gaining more of this resource is a logical reason for hiring a Conestoga team. Experience peace of mind in knowing your newest investment has been installed with the highest level of workmanship provided by a Conestoga construction team.



- Competitive Pricing
- Efficient
- Trained Personnel Ensure Quality
- Satisfaction Guaranteed

Do your logs come from renewable forest practices?

Yes, all our logs come from Forest Stewardship Council (FSC) certified vendors. The engineered logs originate from trees from planted forests and have a much smaller carbon footprint than other log systems.

How long does it take to assemble?

The size of the building and the number of people assembling has a significant impact. Cabins under 800 SQF with a crew of three people should take about three weeks to assemble a basic cabin. Additional time should be added for foundation, running utilities, obtaining construction permits and staining. With larger log homes, with full insulation and finishing, the time would be a few months. We have a crew that can assemble the kit worldwide and would work with your local general contractor. We also have in-house technical support for those that self-build. Here is a link to assembly videos: <http://conestogalogcabins.com/category/assembly-videos/>.

How often is it recommended to re-caulk between the logs?

Because of our engineered logs, there is no need to caulk between the logs. Caulk is used where the logs cross, such as the corners of the cabin. It is recommended to re-stain every five years, which is when the caulk should be inspected and re-caulked as needed.

What are the different grades of insulation used?

We use both fiberglass and Polyiso board. The fiberglass can be R-19 to R-38 and is typically used in floors and ceilings. If wall insulation is needed, one or two layers of Polyiso board is installed. We have log homes in Alaska and many other cold climates and can always meet the local energy code requirements.

Is there a choice of roofs and if so, what are the different types?

We use both shingles and metal in all colors. Our metal roof has a 45 year warranty and shingles have 25-35 year warranty.

What type of foundation is recommended?

Our log buildings have been built on many different types of foundations. Typical foundations are slabs, crawl spaces, piers or full basements.

What is the warranty on the material used?

The entire cabin has a one year warranty. Specific materials have longer warranties, such as the roof for 25-45 years and windows for 20 years. The logs are warranted against splitting for life.

Is there a warranty on the assembly and construction?

A typical construction warranty of one year on the entire cabin is provided. Technical support is also provided free of charge.

Is there a strong sound barrier from the exterior?

Wood naturally absorbs sound, which is why it is used along highways for sound barrier walls. All log cabins provide significantly better sound protection than traditional building systems. Because of less movement and the tight seal of our Everlast™ logs, our cabins are an excellent sound barrier.

Does extreme humidity or cold affect the logs and the caulking?

We have cabins in tropical climates and the cold region of Alaska as well as in all 50 states and 7 foreign markets. Wood grows naturally in all climates. The specific species of wood we use has proven to withstand all climates. We can also meet any snow load or wind load building requirements. One of our customers told us, "The town and neighboring communities where our cabin is located was declared a national disaster area from Hurricane Irene. Our cabin suffered NO damage and is a solid Conestoga log cabin."



